

- 1 COALESSE
- 2 STEELCASE
- 3 STEELCASE HEALTH & STEELCASE EDUCATION
- 4 TURNSTONE
- 5 DESIGNTEX
- 6 INTERFACE
- 7 CONTRACT SOURCE GROUP
- 8 NBS CONSTRUCTION SOLUTIONS (DINOC)
- 9 MDC WALLCOVERING
- 10 BODKINS & ASSOC.
- 11 VISITEC
- 12 BRAD FELSNER ASSOC.
- 13 EPSON
- 14 WIELAND
- 15 HAMPTON PRODUCTS
- 16 NATIONAL

- 17 MCREADY & ASSOC.
- 18 STINSON
- 19 CONTRACT OPTIONS
- 20 SIEBOLD/BAKER ASSOC.
- 21 MILSK CO.
- 22 STELLA GROUP
- 23 MOMENTUM TEXTILES
- 24 VIRGINIA TILE
- 25 PATCRAFT
- 26 CONNECTRAC
- 27 ALLOR GROUP
- 28. PRIMEWAY
- 29 DAVIS CORPORATE SOLUTIONS
- 30 MASLAND
- 31 CRESTRON
- 32 STEELCASE

R=RAFFLE LOCATIONS

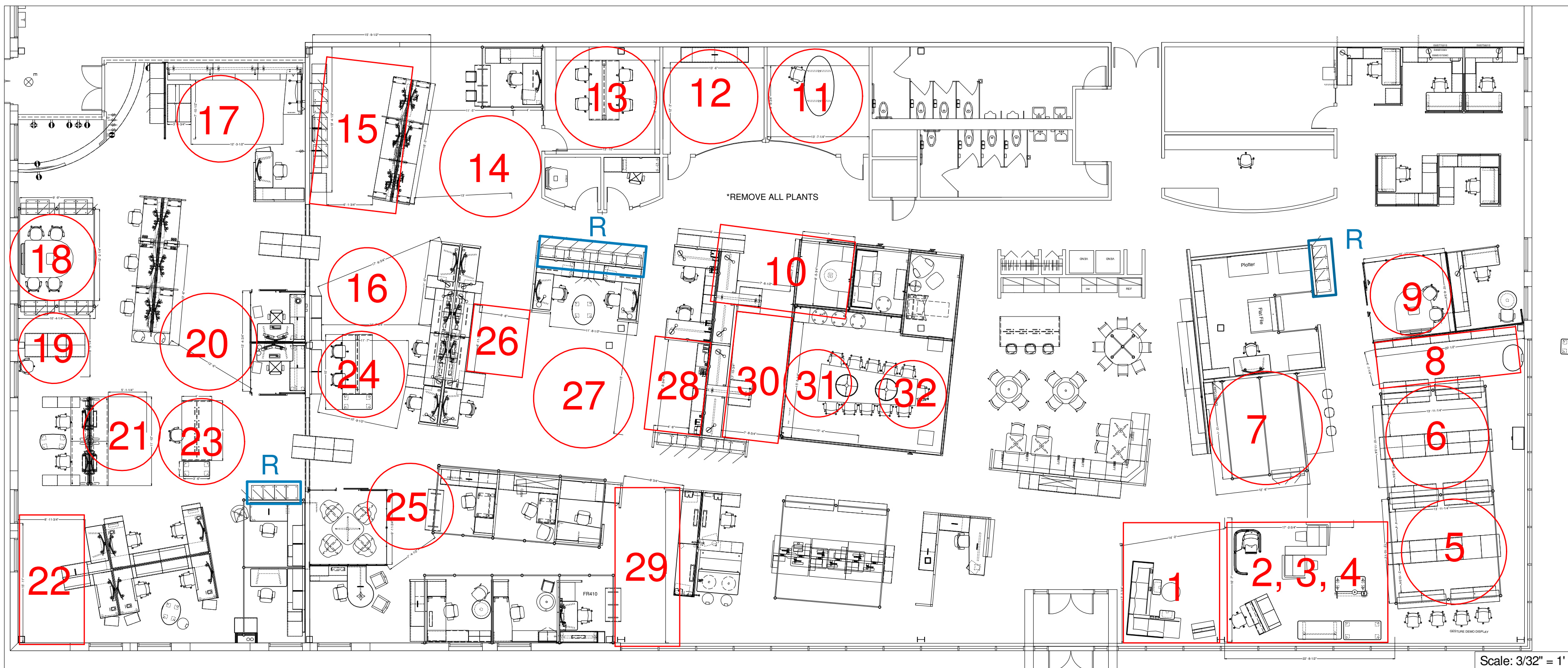

OVERALL

BOOTH LOCATIONS

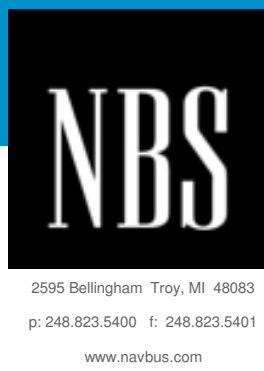

General Notes:
Not for construction
All structural, mechanical and electrical engineering is the responsibility of others.
All furniture and design drawings are in confidence and dissemination may not be made without prior written consent of NBS. All common law rights of copyright and otherwise are hereby specifically reserved.
Final furniture fit and placement is subject to any variation from this plan due to construction changes, field conditions, material differences or changes required for any reason with notification to NBS.
If NBS did not design this project, NBS does not assume responsibility for the design, specification of parts or application of products included in this bid. NBS has only responded to the pricing request for the specifications provided.

09.03.13
00/00/00
00/00/00
00/00/00
00/00/00
00/00/00
00/00/00

Plot Date:
Revision Dates:

Account Executive: HOUSE
Designer: A.ZIELDORFF
Project Manager: M.ROBINSON

NBS [RE]JOCON 2015
TROY SHOWROOM
2595 BELLINGHAM

Project:

Component Plan

F1